

Table of Contents

INTRODUCTION.....	3
Description.....	3
QUADRANT CALIBRATION	3



Introduction

Description

The calibration will be done in hardware without having to use any software.

Quadrant Calibration

1. Device unplugged
2. Link Both Throttle using the provided link bar



3. Move the 2 throttle arms at the lower position as shown:

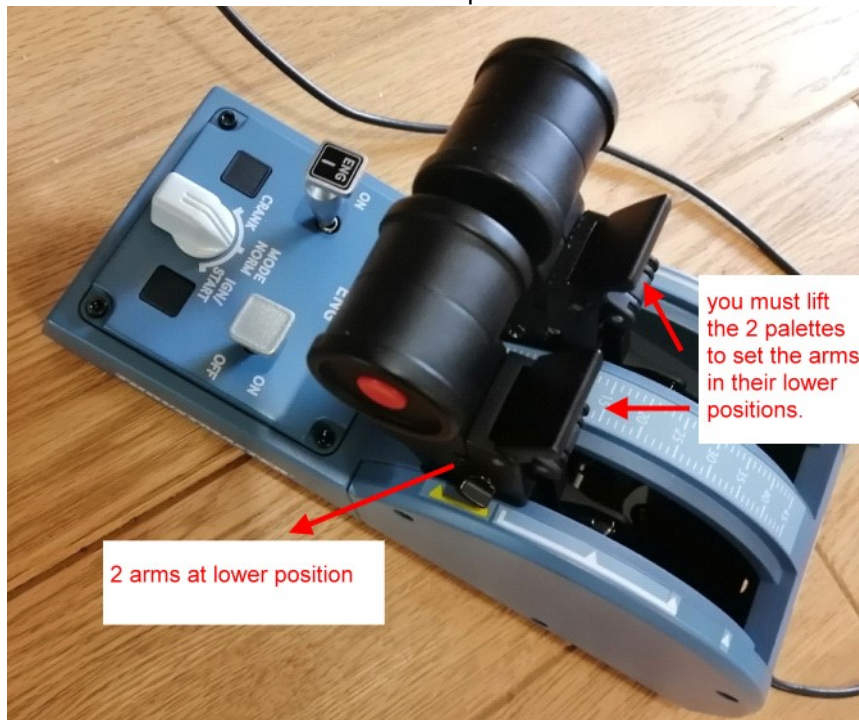

4. By having the firefault2 button press, plug the device to USB to enter in calibration mode

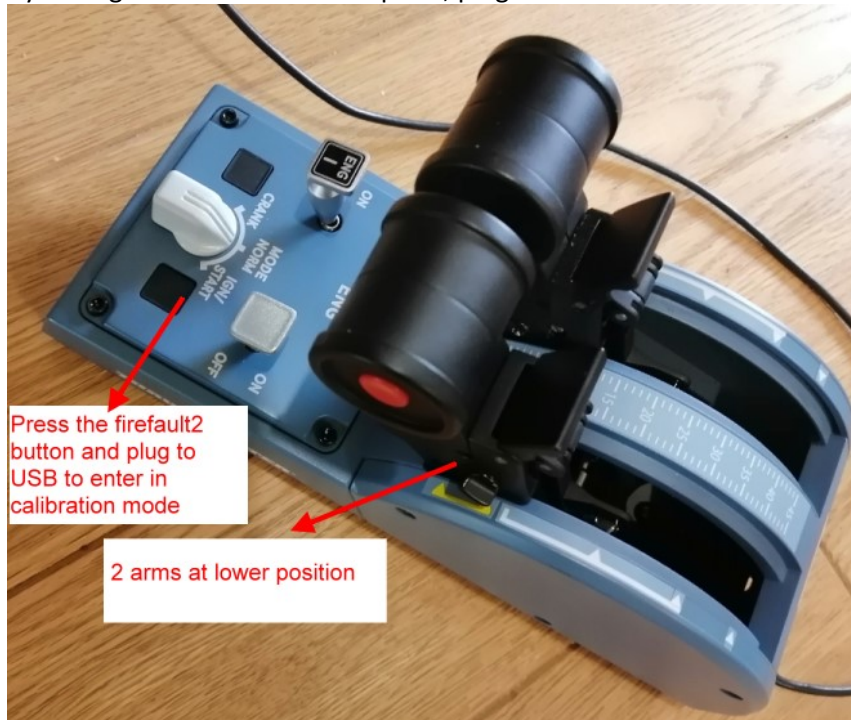

4. Move the 2 throttle arms to their upper positions for calibrating the 2 axes.

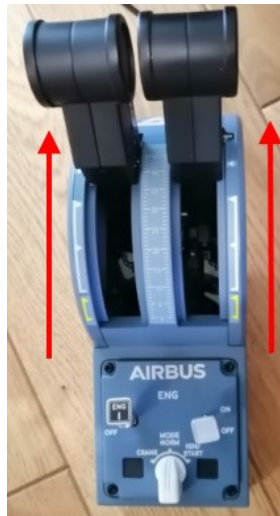

The following steps from 5 to 8 will set the virtual buttons on the throttle's axes

5. Move the arms in their upper position and press both red buttons on the throttle's arms to set buttons 9 & 13



6. Move backward the arms to the next notches and press both red buttons on the throttle's arms to set buttons 10 & 14

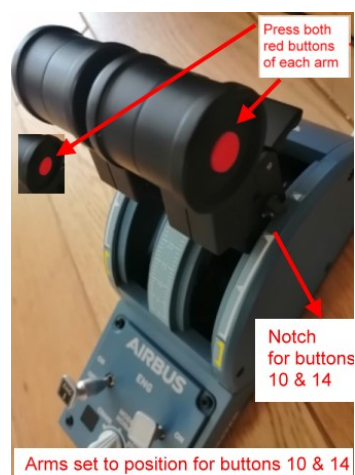

7. Move backward the arms to the next notches and press both red buttons on the throttle's arms to set buttons 11 & 15



8. Move the arms to their lower positions by lifting the 2 palettes and press both red buttons on the throttle's arms to set buttons 12 & 16

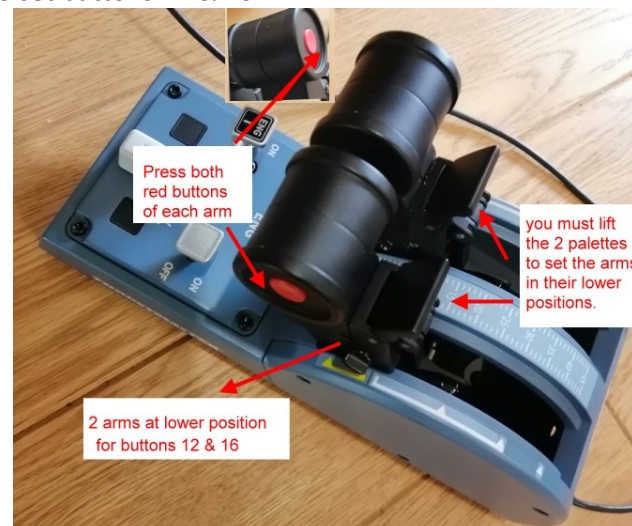

Saving the calibration data inside the device MCU

9. Press simultaneously firefault1 and firefault2 button to save the calibration inside the Quadrant MCU. Release the 2 buttons and then unplug the device from USB

